



## Silicon Carbide Schottky Diode

### ➤ Features

VR	IF	VF
650V	2A	1.4V

### ➤ Description

- 650V Schottky Rectifier
- High Frequency Operation
- Extremely Fast Switching
- Positive Temperature Coefficient on  $V_F$

### ➤ Applications

- Power Supplies
- Power Factor Correction
- Motor Drives

### ➤ Ordering Information

Device	Package	Shipping
SSC65002AT8	TO252-2L	2.5K/Reel

### ➤ Pin Configuration

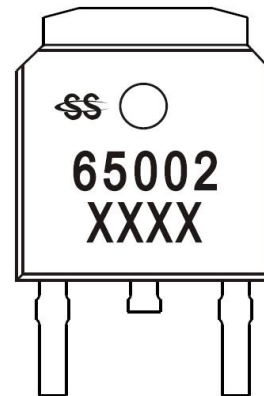
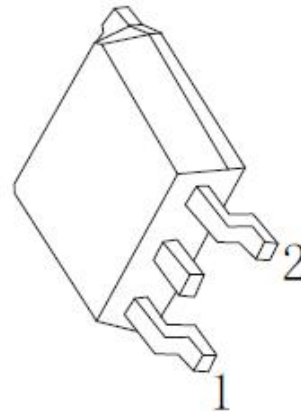

Marking

(XXXX: Year/Week)



➤ **Absolute Maximum Ratings**(TA=25°C unless otherwise noted)

Symbol	Parameter		Ratings	Unit
V <sub>RRM</sub>	Repetitive Peak Reverse Voltage		650	V
V <sub>RSM</sub>	Surge Peak Reverse Voltage		650	V
V <sub>DS</sub>	DC Blocking Voltage		650	V
I <sub>F</sub>	Continuous Forward Current	T <sub>C</sub> =150°C	2	A
I <sub>FRM</sub>	Repetitive Peak Forward Surge Current <sup>A</sup>		11	A
I <sub>FSM</sub>	Non-Repetitive Peak Forward Surge Current <sup>A</sup>		16	A
I <sub>F MAX</sub>	Non-Repetitive Peak Forward Surge Current <sup>B</sup>		120	A
P <sub>TOT</sub>	Power Dissipation	T <sub>C</sub> =25°C	39	W
T <sub>J</sub> T <sub>STG</sub>	Operating Junction and Storage Temperature		-55~+175	°C

➤ **Thermal Resistance Ratings**(TA=25°C unless otherwise noted)

Symbol	Parameter	Ratings	Unit
R <sub>θJC</sub>	Thermal Resistance Junction-to-Case	3.8	°C/W

Note:

A. T<sub>C</sub>=25°C, t=10ms, Half Sine Wave;

B. T<sub>C</sub>=25°C, t=10us, Pulse;



## SSC65002AT8

➤ **Electronics Characteristics**(TA=25°C unless otherwise noted)

Symbol	Parameter	Test Conditions	Typ.	Max.	Unit
V <sub>F</sub>	Forward Voltage	IF=2A TJ=25°C	1.4	1.8	V
		IF=2A TJ=175°C	1.8	2.1	
I <sub>R</sub>	Reverse Current	VR=650V TJ=25°C	1	20	uA
		VR=650V TJ=175°C	12	100	
Q <sub>C</sub>	Total Charge	VR=400V IF=2A TJ=25°C	4.8		nC
C	Total Capacitive	VR=0V TJ=25°C f=1MHz	95		pF
		VR=200V TJ=25°C f=1MHz	10		
		VR=400V TJ=25°C f=1MHz	9		
E <sub>C</sub>	Capacitance Stored Energy	VR=400V	1.4		uJ



➤ Typical Characteristics (TA=25°C unless otherwise noted)

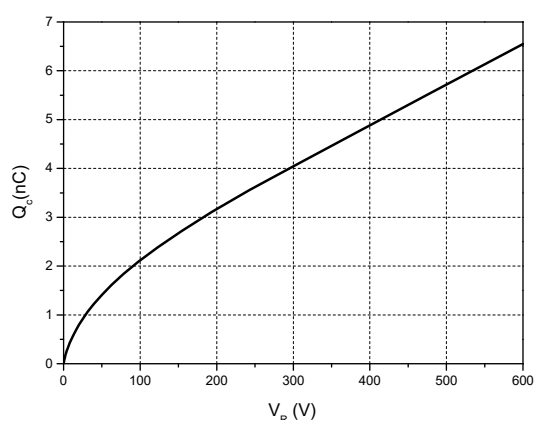
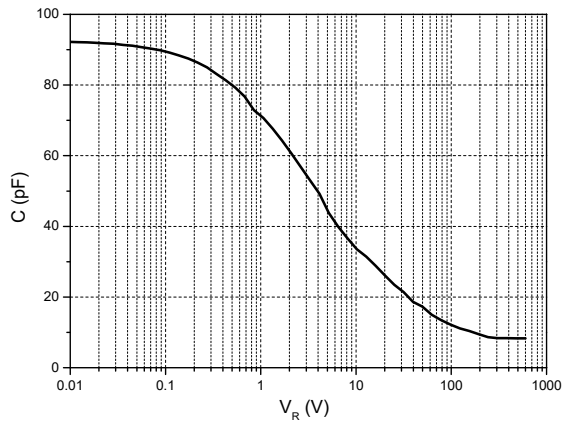
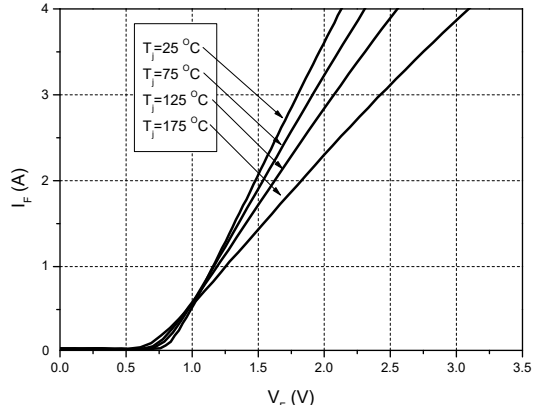
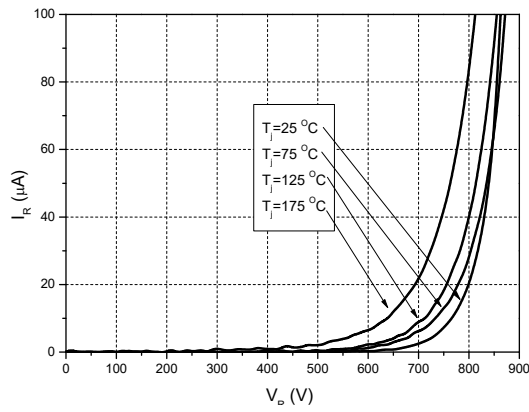

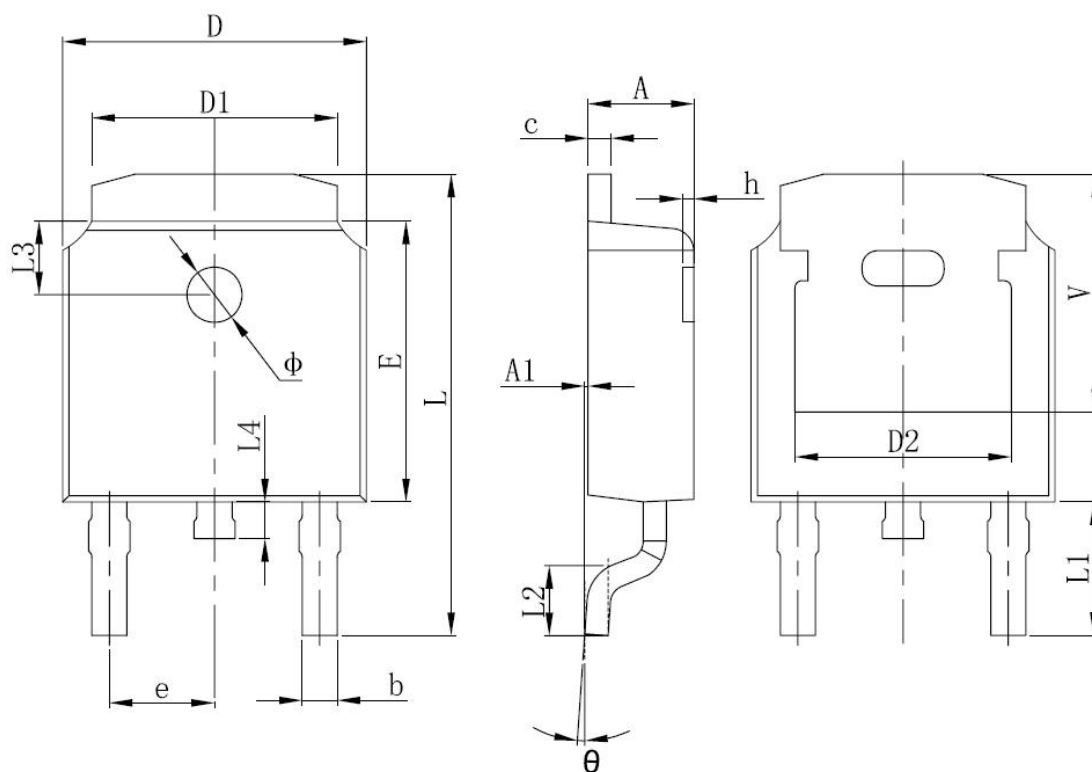
**➤ Package Information**

Symbol	Dimensions In Millimeters		Dimensions In Inches	
	Min.	Max.	Min.	Max.
A	2.200	2.400	0.087	0.094
A1	0.000	0.127	0.000	0.005
b	0.635	0.770	0.025	0.030
c	0.460	0.580	0.018	0.023
D	6.500	6.700	0.256	0.264
D1	5.100	5.460	0.201	0.215
D2	4.830 REF.		0.190 REF.	
E	6.000	6.200	0.236	0.244
e	2.186	2.386	0.086	0.094
L	9.712	10.312	0.382	0.406
L1	2.900 REF.		0.114 REF.	
L2	1.400	1.700	0.055	0.067
L3	1.600 REF.		0.063 REF.	
L4	0.600	1.000	0.024	0.039
Φ	1.100	1.300	0.043	0.051
θ	0°	8°	0°	8°
h	0.000	0.300	0.000	0.012
V	5.250 REF.		0.207 REF.	



**DISCLAIMER**

SSCSEMI RESERVES THE RIGHT TO MAKE CHANGES WITHOUT FURTHER NOTICE TO ANY PRODUCTS HEREIN TO IMPROVE RELIABILITY, FUNCTION OR DESIGN. SSCSEMI DOES NOT ASSUME ANY LIABILITY ARISING OUT OF THE APPLICATION OR USE OF ANY PRODUCT OR CIRCUIT DESCRIBED HEREIN; NEITHER DOES IT CONVEY ANY LICIENCE UNDER ITS PATENT RIGHTS, NOR THE RIGHTS OF OTHERS.

THE GRAPHS PROVIDED IN THIS DOCUMENT ARE STATISTICAL SUMMARIES BASED ON A LIMITED NUMBER OF SAMPLES AND ARE PROVIDED FOR INFORMATIONAL PURPOSE ONLY. THE PERFORMANCE CHARACTERISTICS LISTED IN THEM ARE NOT TESTED OR GUARANTEED. IN SOME GRAPHS, THE DATA PRESENTED MAY BE OUTSIDE THE SPECIFIED OPERATING RANGE (E.G. OUTSIDE SPECIFIED POWER SUPPLY RANGE) AND THEREFORE OUTSIDE THE WARRANTED RANGE.

OUR PRODUCT SPECIFICATIONS ARE ONLY VALID IF OBTAINED THROUGH THE COMPANY'S OFFICIAL WEBSITE, CRM SYSTEM, OR OUR SALES PERSONNEL CHANNELS. IF CHANGES OR SPECIAL VERSIONS ARE INVOLVED, THEY MUST BE STAMPED WITH A QUALITY SEAL AND MARKED WITH A SPECIAL VERSION NUMBER TO BE VALID.